

PART SITE PLAN OF GOEL BHAWAN MAIN BELONGING TO SHRI KRISHAN KUMAR GOEL S/O LATE SHRI SUMER CHAND GOEL AT BALA HISAR MUSSORRIE .

NOTE:- BOUNDARY OF THE SOLD PORTION HAS BEEN MARKED BY THE RED RIBBAND

OPEN AREA = 00.00 SQ.FT & 00.00 SQ.MT
 COVERED AREA = 1871.28 SQ.FT & 173.91 SQ.MT
 TOTAL AREA =
 SELLER = MR. KRISHAN KUMAR GOEL
 PURCHASER =

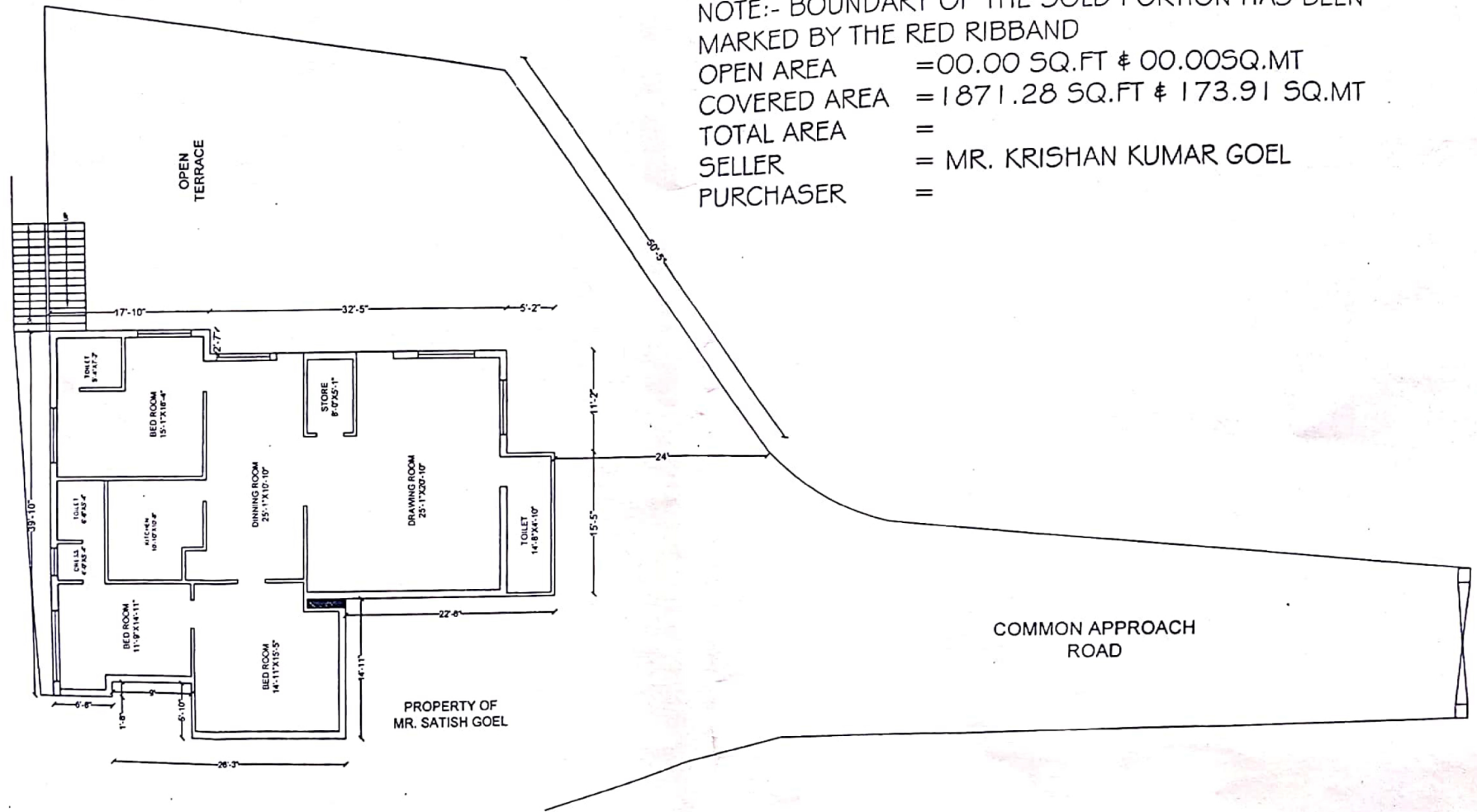



C. B. M. Form No. 101

नगर पालिका
CITY BOARD

भवन एवं भूमि के वार्षिक मूल्यांकन पर
Assessment List for Taxes on Annual

For the Period From 1968-69

क्र. सं.	Name of street or Mohalla in which the property is situated वाड़ें या मुहल्ले का नाम जहाँ भवन स्थित है।	Designation of property by Name or number भवन का नाम या संख्या।	Name and address of the owner (and agent if any) भवन के मालिक का नाम व पता	Name of occupier and when there are more occupiers than (one rent by each) किरायेदार/वाहने का नाम तथा किराये की धनराशि	Proposed Annual Value प्रस्तावित वार्षिक मूल्यांकन
1	2	3	4	5	6
					Rs. P.
			Vide T.A. case no. 2 3-5-69 स. अ. अस्पष्ट		900 - 00
		Goel Bhasan upper Historia upper Tahas	Same land Sr. Kapoor chand		
		" Lower	do		800 - 00
			Vide T.A. case no. 8th 3-5-69 स. अ. अस्पष्ट		600 - 00
		Saxle. Sahan Mestera Annari	Saxle. Duni Sani w/o Sr. Bin Prakash		
		Cor-shed at Seila Sahan	do		
			Vide T.A. case no. 2 3-5-69 स. अ. अस्पष्ट		200 - 00
		Daya Bhanan Out-Houses	Daya Nand S/o Sr. Kapoor Chand		

- Date on which application was made for copy accompanied by the requisite Stamp..... 25/1/69
- Copied by..... Date..... 25/1/69
- Checked by..... Date..... 25/1/69
- Time when the copy was ready for.....
- Time when the copy was ready for notice.....
- Time of delivery of copy.....



मसूरी

MUSSOORIE

करों की प्रोसेसमेंट प्रॉजिजका

Value of Building and Lands

के वर्ष

101990-91

Amount of house tax assessed भवन कर Amount of water tax assessed जलकर Result of Appeal if any Remarks including reference to orders in case of subsequent increases and decrease
 कर निर्धारण के पश्चात यदि कोई बढ़ोतरी/घटोतरी हो तो उसका विवरण आदेशों सहित

7		8		9			10		11		12
Rs.	P.	Rs.	P.	Rs.	P.	Rs.	P.	Rs.	P.		
90	00	54	00	450	00	45	00	29	00	Area 1.6 acres (Part Ist)	
80	00	48	00	600	00	60	00	26	00		
60	00	36	00	300	00	30	00	18	00	Area 0.8 acres (Part Ist)	
										Assessed at Rs 50/- p.a. With Committee 220 362 Pt. 7 470. 22.1 - illegible 18.11.90	
20	00	12	00	75	00	7	50	4	50	Area 0.6 acres (Part Ist)	

TRUE COPY
 Office Supdr.
 For Executive Officer,
 City Board, Mussoorie.
 20/11/89

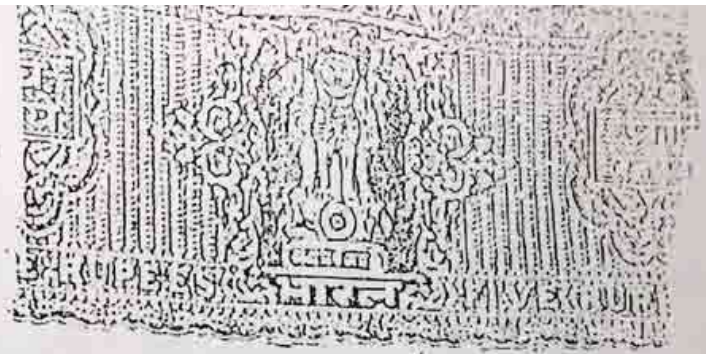

नगर पालिका
CITY BOARD

Assessment List for Taxes on Annual

For the Period from 1968-69

Serial No. क्र.सं.	Name of street or locality in which the property is situated पथ वा पुराने वा नाम जहाँ भवन स्थित है।	Description of property by Name or number पथ वा नाम वा क्रमांक	Name and address of the tenant नाम वा पता	Name of occupier and when there are more occupiers than one rent by each निवासी, पालिका वा नाम वहाँ कति वा पालिका	Proposed Annual Value सालाना मूल्य मूल्यांकन
1	2	3	4	5	6

19

Godhawan upper v.t. 3 S. 67
Mastan upper Sadan
Sama Chaud Ye
Kafan Chaud

900 - 00

" Lower

800 - 00

20

Sarla Sadan v.t. 3 S. 67
Mastan upper Sadan
Si. Sadan
Parbakh

600 - 00

20A

Par. Shalvi Sadan

20B

Daya Bhat v.t. 3 S. 67
Put. Sadan
Day. Sadan
Si. Sadan
Chaud

800 - 00

- Date on which application was made for copy accompanied by requisite Stamp. 21.1.69
- Copied by [Signature] Date 21.1.69
- Checked by [Signature] Date 21.1.69
- Date on which the copy was ready for delivery and posted on notice Board. 21.1.69
- Date of delivery of copy. 21.1.69
- Signature of officer. [Signature]